



Digital Palettes

CI3000 / CI5000 /HR6000

January 1995

TO ORDER PARTS, CONTACT:

Polaroid Corporation
Parts Logistics Department
201 Burlington Road
Bedford MA 01730
TEL: 1.800.343.4846
FAX: 1.781.386.5606

Give PART NUMBER, full PART NAME, and QUANTITY desired. Merchandise returns accepted only upon written authorization. Parts carry a replacement warranty for 90 days from date of purchase.

Americas Business Center
Technical Services
TEL: 1.781.386.5309
FAX: 1.781.386.5988

PLATE 1
MAIN ASSEMBLY

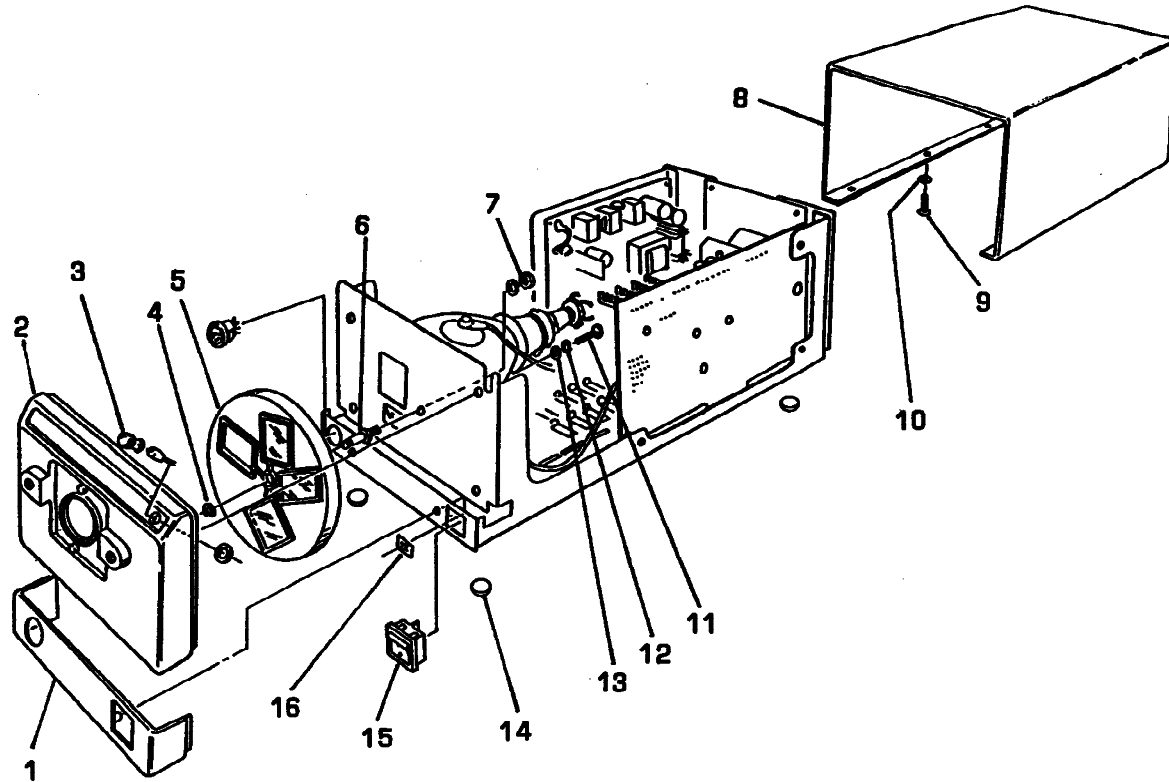

PARTS LIST 1
MAIN ASSEMBLY

KEY NO.	PART NO.			PART NAME
	CI3000	CI5000	HR6000	
1	1A3590A	1A3590A	1A3590D	Control Panel
2	761405L	761405L	761405S	Front Housing
3	770987A	770987A	770987A	LED Holder
4	768431G	768431G	768431G	E-Ring, Filter Wheel Pivot
5	761491B	761491B	761491B	Filter Wheel Assembly
6	761752A	761752A	761752A	Pivot, Filter Wheel
7	768117A	768117A	768117A	KepsNut, #4-40 (Filter Wheel Pivot)
8	1A3646A	1A3646A	1A3646D	Cover
9	735871C	735871C	735871C	Screw, Phillips Panhead, 6-32 x .250"
10	735306A	735306A	735306A	Star Washer, #6, Internal Tooth
11	800083-404	800083-404	800083-404	Button Head Cap Screw (Stainless), 10-24 x .625"
12	800012-301	800012-301	800012-301	Split Washer, #10, Stainless Steel
13	800158-135	800158-135	800158-13581	Flat Washer, #10, Stainless Steel
14	766374C	766374C	766374C	Bumper (Rubber Foot)
15	766177A	766177A	766177A	Power Switch
16	1A3865A	1A3865A	1A3865A	Stud Receiver

PLATE 2
CHASSIS COMPONENTS

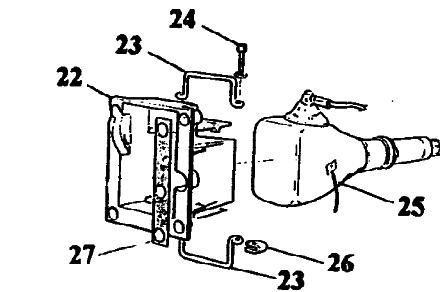
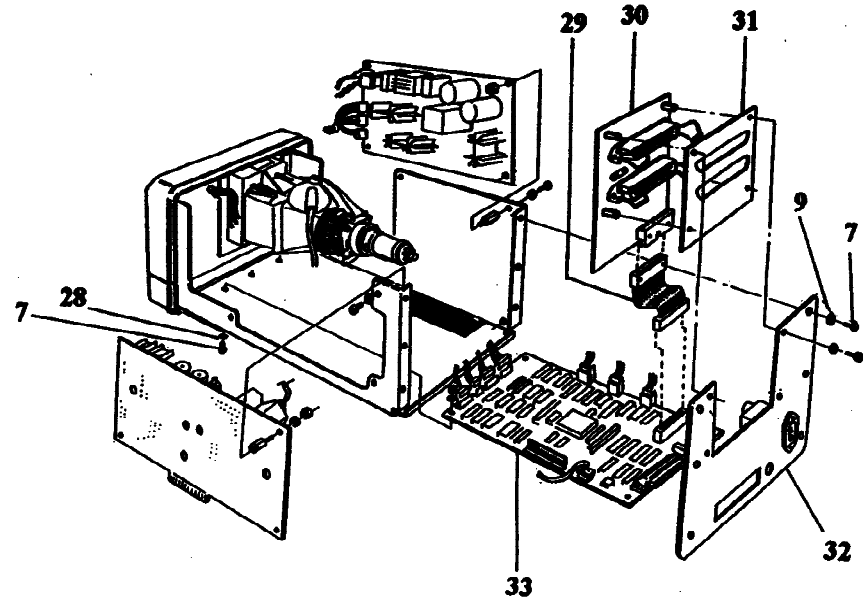
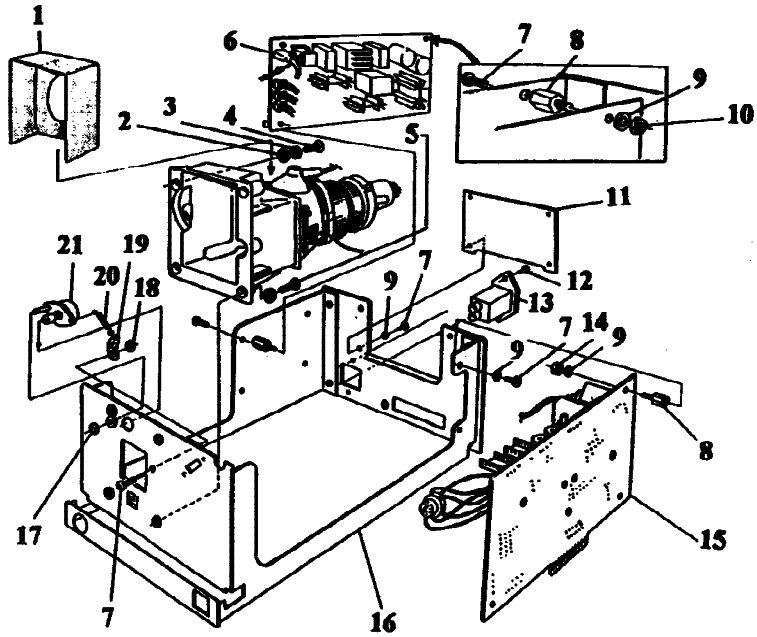

CI3000/CI5000

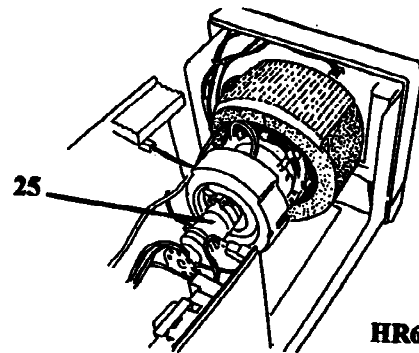

HR6000

PARTS LIST 2
CHASSIS COMPONENTS

KEY NO.	PART NO.			PART NAME
	CI3000	CI5000	HR 6000	
1	1A6350A	1A6350A	1A6350A	Light Shield
2	768211B	768211B	768211B	Flat Washer
3	703141	703141	703141	Lockwasher
4	743040M	743040M	743040M	Screw
5	743040F	743040F	743040F	Screw
6	1A4567A	1A4567A	1A4567A	Switching Power Supply (Conv. Concepts)
7	735871C	735871C	735871C	Phillips Panhead Screw, 6-32 x .25" (6)
8	770355A	770355A	770355A	Spacer, Male/Female, 6-32 x .25" Hex (2)
9	735306A	735306A	735306A	Star Washer, #6 Internal Tooth (5)
10	768117C	768117C	768117C	Keps Nut
11	1A3651A	1A3651A	1A3651A	Blank Panel (Centronics)
12	7033120	7033120	7033120	Oval Head Pop Rivet, .313" Long
13	766642B	766642B	766642B	Line Filter Assembly
14	209895	209895	209895	Nut
15	1A3743A	1A3743A	1E4391A	Monitor Board Assembly
16	1A3513A	1A3513A	1A3513A	Chassis Weldment
17	768431G	768431G	768431G	E-Ring
18	768117A	768117A	768117A	Nut
19	1857290	1857290	1857290	Terminal Lug, Shakeproof #6
20	715698A	715698A	715698A	Pick Return Spring
21	768094C	768094C	768094C	Stepper Motor and Cable Assembly
22	761493C	761493C	761493C	Monitor Support
23	766094A	766094A	766094A	Monitor Clamp (2)
24	743040M	743040M	743040M	Cap Screw, Socket Head, 8-32 x 1.375" Long (2)
25	783722C	783722C	1E8130A	CRT and Yoke Assembly
26	766457A	766457A	766457A	Fastener, U-Type, 8-32
27	768103A	768103A	768103A	Shim, Left Side, 0.005" (As Required)
	768103B	768103B	768103B	Shim, Left Side, 0.010" (As Required)
	768103C	768103C	768103C	Shim, Left Side, 0.020" (As Required)
	768104A	768104A	768104A	Shim, Right Side, 0.005" (As Required)
	768104B	768104B	768104B	Shim, Right Side, 0.010" (As Required)
	768104C	768104C	768104C	Shim, Right Side, 0.020" (As Required)
28	701705B	701705B	701705B	Star Washer, #6 External Tooth
29	--	1A3983A	1A3983A	SCSI Ribbon Cable (SCSI Board to Logic Board)
30	--	1A5694A	1A5694A	SCSI Board Assembly
31	--	1A3645A	1A3645A	SCSI Adapter Panel
32	1A3514A	1A3514A	1A3514A	Chassis Back Plate
33	1D6749D	1D6749D	1D6749D	Logic Board Assembly (Surface Mount)

PLATE 3
CABLES

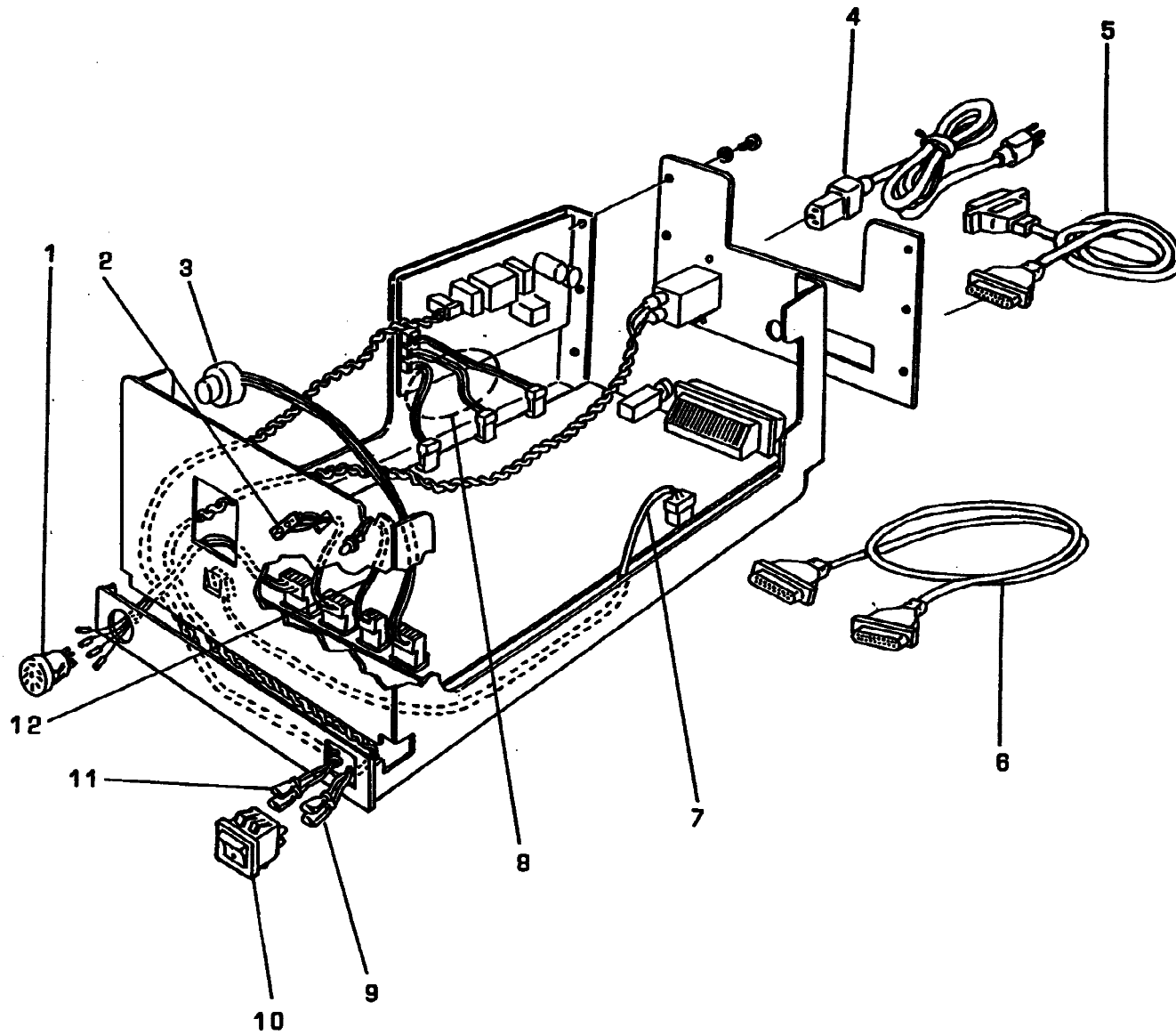

PARTS LIST 3
CABLES

KEY NO.	PART NO.			PART NAME
	CI3000	CI5000	HR6000	
1	1A3882A	1A3882A	1A3882A	Camera Cable Assembly (DIN to Logic Board)
2	761250C	761250C	761250C	Wheel Position Sensor Cable Assembly
3	768094C	768094C	768094C	Stepper Motor and Cable Assembly
4	730933	730933	730933	AC Power Cord Set (110V, U.S.A. Type)
5	--	1A6747A	1B0351A	SCSI Interface Cable
6	1A5556A	1A5556A	1A5556A	Centronics Parallel Cable
7	1A5571A	1A5571A	1A5571A	Photocell and Wire Assembly
8	1A3884A	1A3884A	1A3884A	DC Power Cable (Power Supply to Logic Board)
9	1A3878A	1A3878A	1A3878A	Power Cable Assembly (Line Filter to Power Switch)
10	766177A	766177A	766177A	Power Switch
11	1A3880B	1A3880B	1A3880B	Power Supply Cable Assembly (Power Switch to Power Supply)
12	1A5543A	1A5543A	1A5543A	Power Indicator LED (Green) and Cable Assembly
Not Shown	1A3881A	1A3881A	1A3881A	Ground Wire Assembly (Power Supply Ground Cable)

PLATE 4
35MM CAMERA AND ADAPTER ASSEMBLY

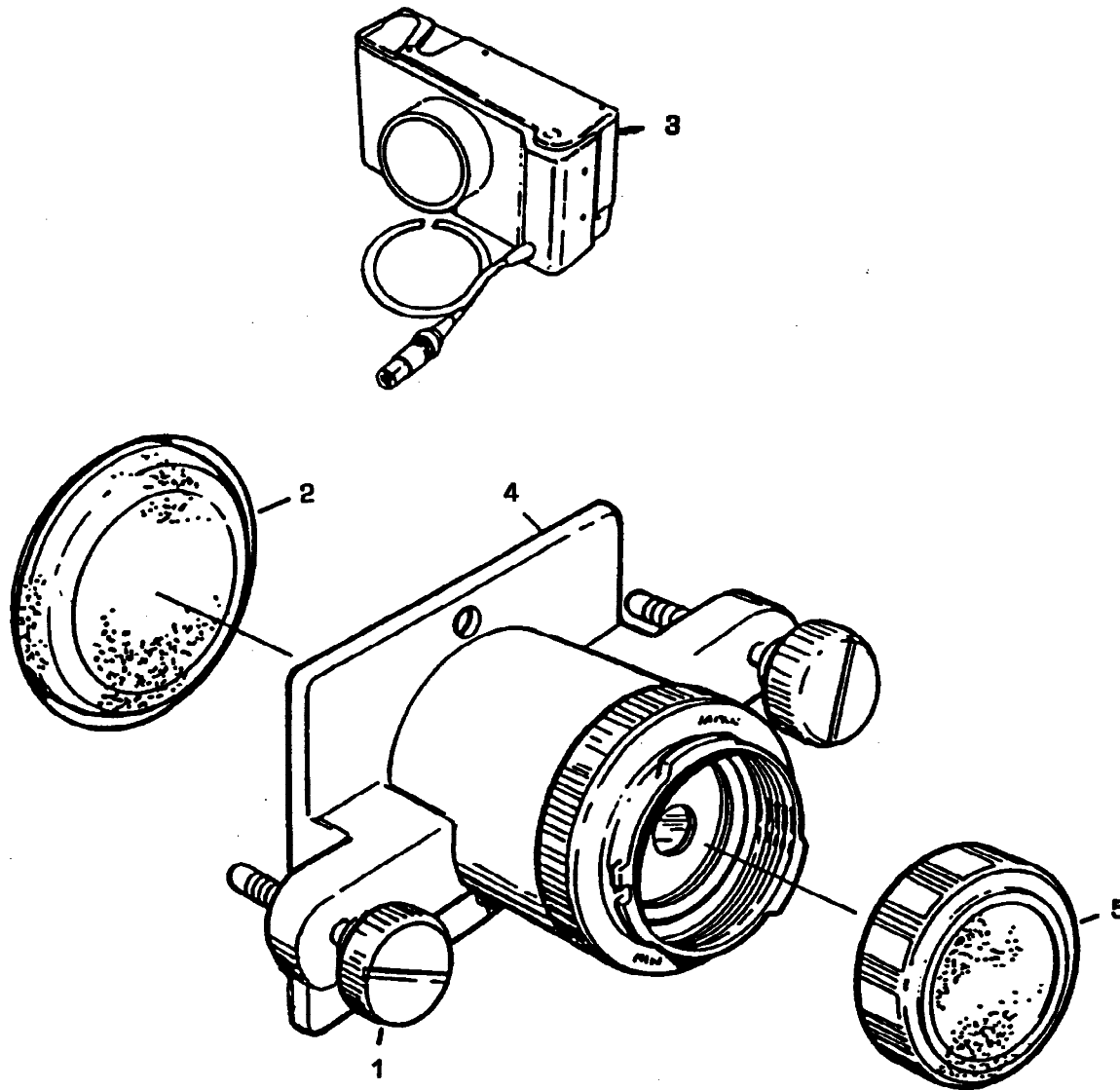

PARTS LIST 4
35MM CAMERA AND ADAPTER ASSEMBLY

KEY NO.		PART NO.		PART NAME
	CI3000	CI5000	HR6000	
1	766783B	766783B	776783D	Thumb Screw (2)
2	766872B	766872B	766872B	Button Plug, Recessed
3	768423K	768423K	768423M	Camera Back (3:2 Aspect Ratio, Full Frame)
4	776260E	776260E	776260EH	35MM Adapter Plate Assembly
5	766990A	766990A	766990A	Lens Cap

PLATE 5
CB-108 CAMERA ADAPTER ASSEMBLY

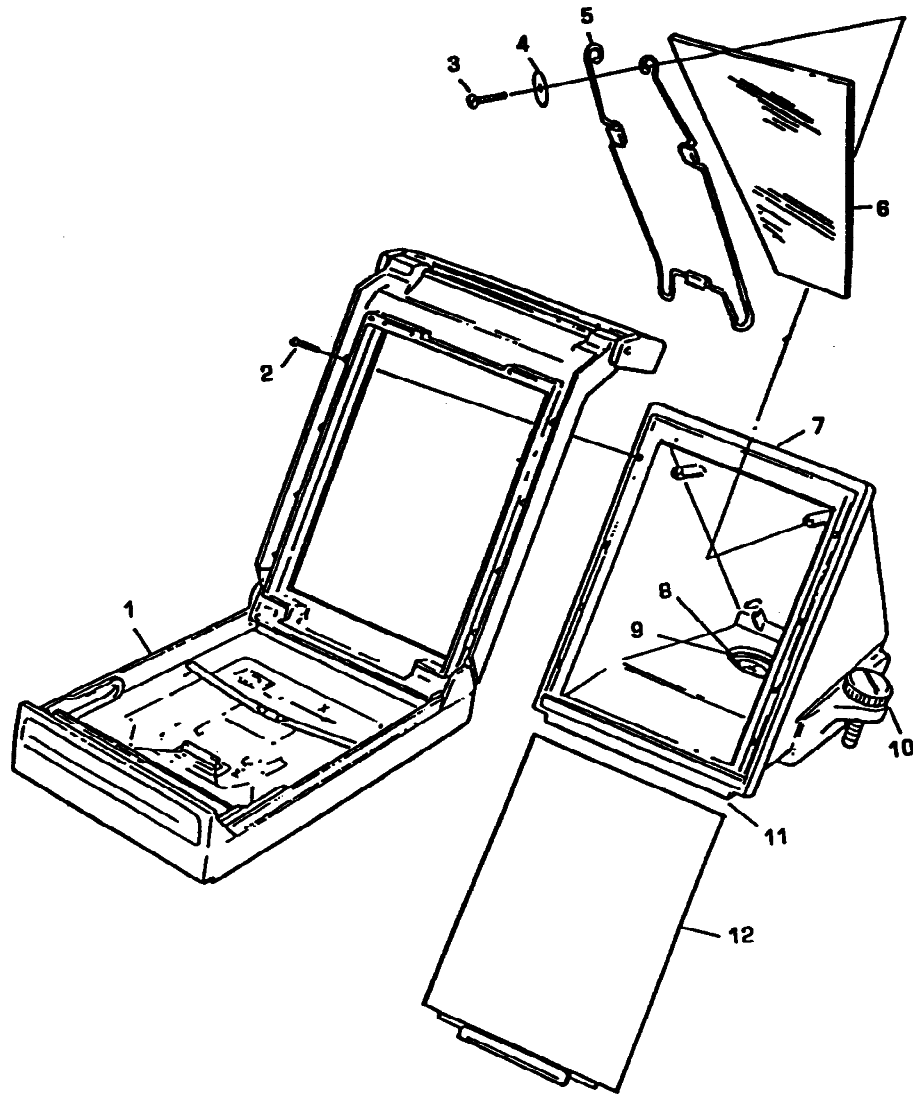

PARTS LIST 5
CB-108 CAMERA ADAPTER ASSEMBLY

KEY NO.	PART NO.	PART NO.	PART NO.	PART NAME
	CI3000	CI5000	HR6000	
1	See Plate 6	See Plate 6	See Plate 6	CB-103 Camera Back
2	735179E	735179E	735179E	Screw, Plastite Panhead
3	743333B	743333B	743333B	Screw, Plastite Panhead, #6-19 x 0.38 Long (2)
4	80015B-125	80015B-125	80015B-125	Flat Washer, #6 (2)
5	766296C	766296C	766296C	Mirror Retainer
6	766298B	766298B	766298B	Mirror
7	766299E	766299E	766299E	Cone Assembly (Includes Key Numbers 3, 4, 5, 6, and 8)
8	794747A	794747A	794747A	Lens and Aperture Assembly
9	766990A	766990A	766990A	Lens Cap
10	766783A	766783A	766783A	Thumb Screw, 1/4-20 thd (2)
11	766293B	766293B	766293B	Light Seal Filmholder
12	766653B	766653B	766653B	Darkslide Assembly

PLATE 6
CB-103 CAMERA BACK

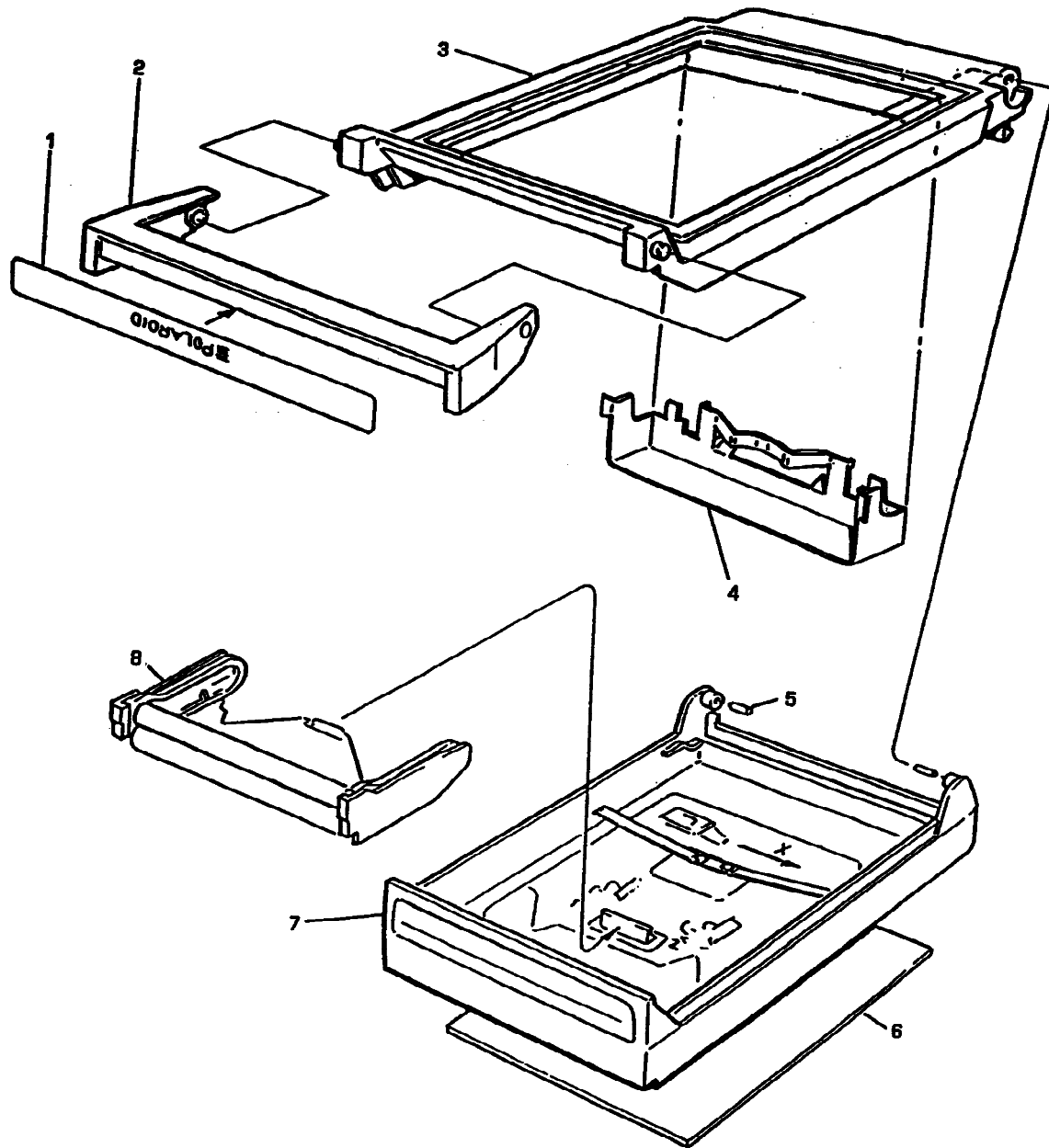

PARTS LIST 6
CB-103 CAMERA BACK

KEY NO.	PART NO.			PART NAME
	CI3000	CI5000	HR6000	
1	758173A	758173A	758173A	Decal, Latching Cover
2	758172A	758172A	758172A	Latching Cover
3	758162A	758162A	758162A	Body Assembly
4	783659B	783659B	783659B	Snap Pack Cap
5	743714N	743714N	743714N	Dowel Pin (Pivot)
6	758170A	758170A	758170A	Leather Insert
7	758165B	758165B	758165B	Cover Assembly
8	735965D	735965D	735965D	Spread Roller Assembly (AD11)

PLATE 7
CB-33 AUTOFILM CAMERA BACK

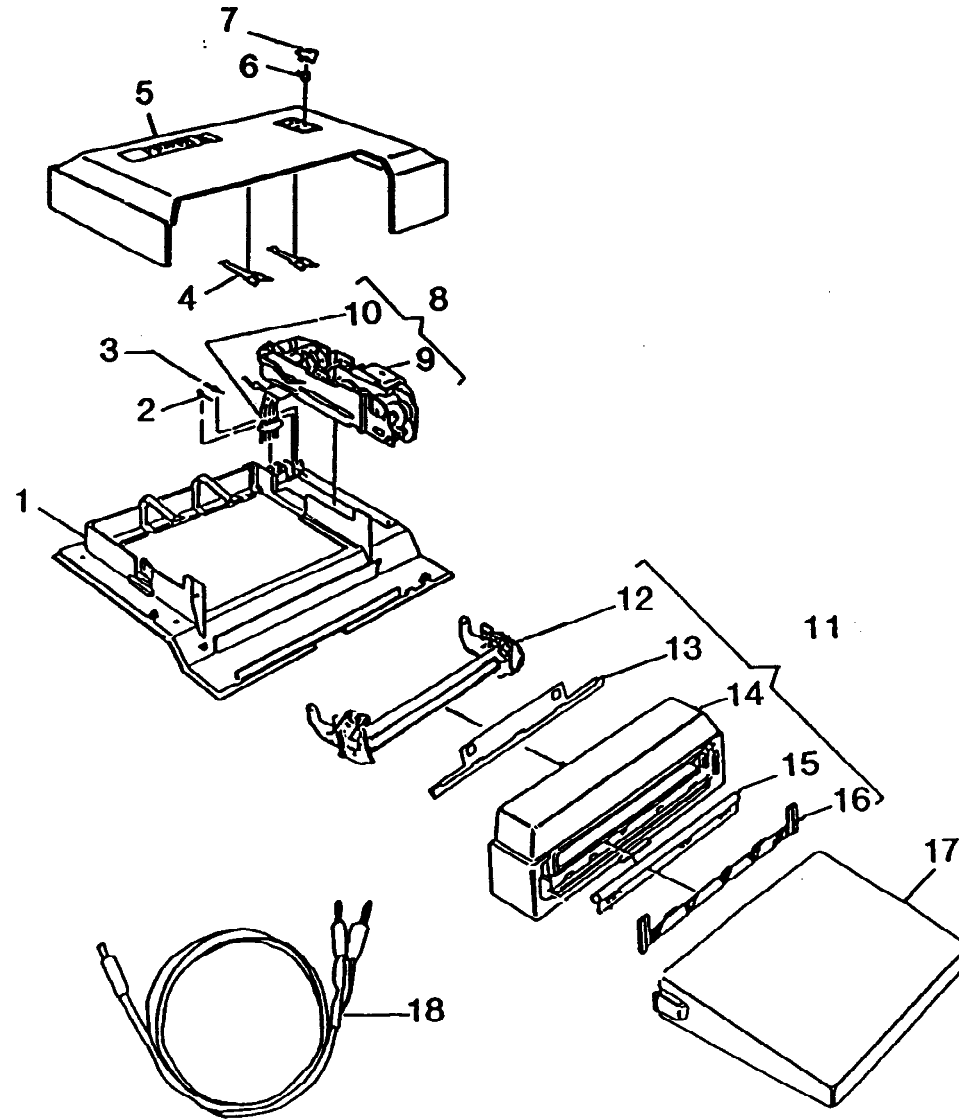

PARTS LIST 7
CB-33 AUTOFILM CAMERA BACK

KEY NO.	PART NO.		PART NAME	
	CI3000	CI5000	HR6000	
1	761152C	761152C	761152C	Main Frame
2	761955A	761955A	761955A	Power Jack Contact
3	761954A	761954A	761954A	Power Jack Pin
4	715732	715732	715732	Pack Spring (2)
5	761147D	761147D	761147D	Cover Assembly (Includes Key Numbers 6 and 7)
6	761149A	761149A	761149A	S1 Return Spring
7	761150A	761150A	761150A	S1 Button
8	761153B	761153B	761153B	5V Drive Module (Includes Key Numbers 9 and 10)
9	768252B	768252B	768252B	5V Motor
10	761942A	761942A	761942A	Cable
11	761143C	761143C	761143C	Door Assembly (Includes Key Numbers 12 through 16)
12	Not Stocked	Not Stocked	Not Stocked	Roll Assembly
13	770052A	770052A	770052A	Exit Guide
14	761144B	761144B	761144B	Door
15	761145A	761145A	761145A	Frog's Tongue
16	761146A	761146A	761146A	Gripper
17	761727	761727	761727	Imbibing Chamber
18	13098	13098	13098	Test Cord, 5V
Not Shown	770115A	770115A	770115A	DC Power Plug

PLATE 8
CB-33 ADAPTER

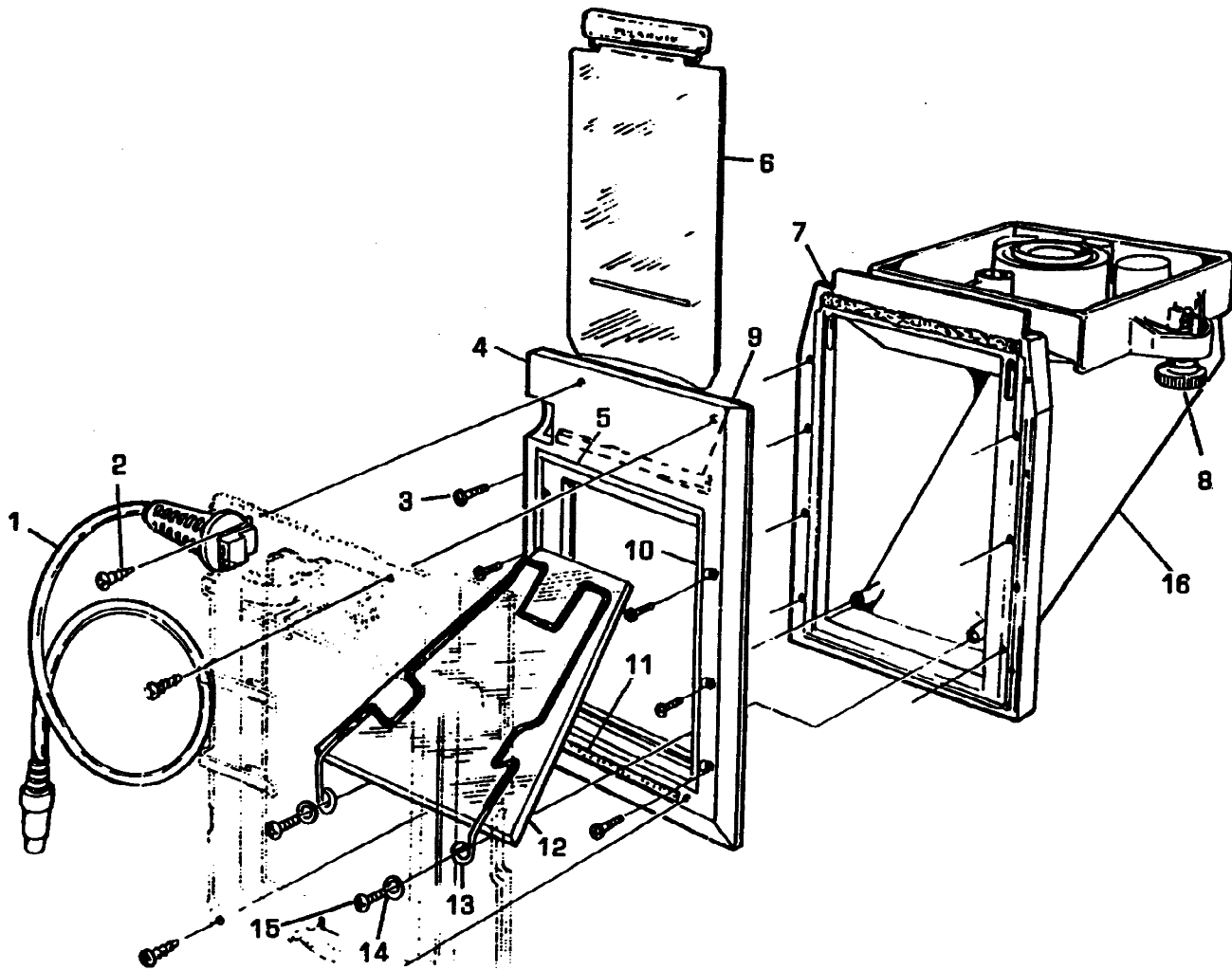

PARTS LIST 8
CB-33 ADAPTER

KEY NO.	PART NO.	PART NO.	PART NAME	
	CI3000	CI5000	HR6000	
1	776171A	776171A	776171A	Interface Cable
2	743459C	743459C	743459C	Screw (4)
3	743634K	743634K	743634K	Screw, #2-28, Plastite (7)
4	776154A	776154A	776154A	CB-33 Spacer
5	768175C	768175C	768175C	Light Seal (2)
6	776292A	776292A	776292A	Dark Slide Assembly
7	766650A	766650A	766650A	Light Seal Assembly
8	766783A	766783A	766783A	Thumbscrew (2)
9	766293B	766293B	766293B	Light Seal
10	768175B	768175B	768175B	Light Seal (2)
11	766293B	766293B	766293B	Light Seal
12	766298B	766298B	766298B	Mirror
13	766296C	766296C	766296C	Coated Mirror Retainer
14	800158-125	800158-125	800158-125	Washer, Plain #6
15	743333B	743333B	743333B	Screw (4)
16	766299E	766299E	766299E	Cone Assembly

PLATE 9
PACKAGING AND ACCESSORIES

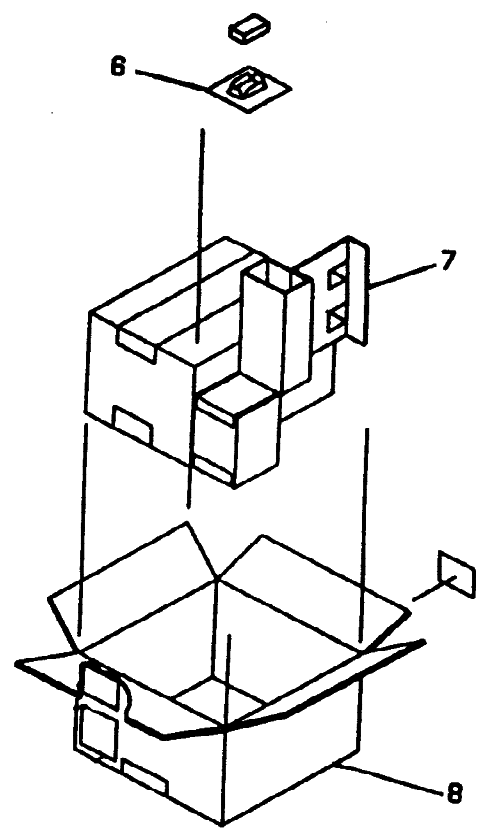
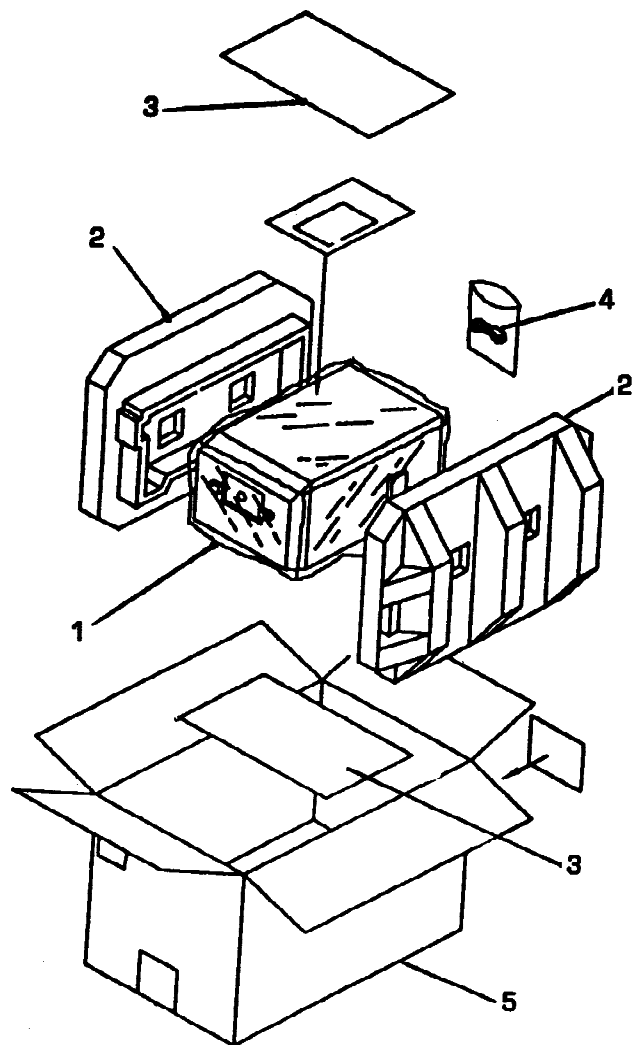

PARTS LIST 9
DIGITAL PALETTE PACKAGING

KEY NO.	PART NO.			PART NAME
	CI3000	CI5000	HR6000	
1	765132	765132	765132	Poly Bag
2	796642A	796642A	796642A	Side Cap (2)
3	796999A	796999A	796999A	Gap Pad (2)
4	730933	730933	730933	Domestic Cord Set
5	1A4122A	1A4122A	1A4122A	Shipping Container
6	----	----	1D2925A	Insert 1
7	----	----	1D2926A	Insert 2
8	----	----	796995A	Shipping Container

PLATE 10
35MM CAMERA ADAPTER PACKAGING

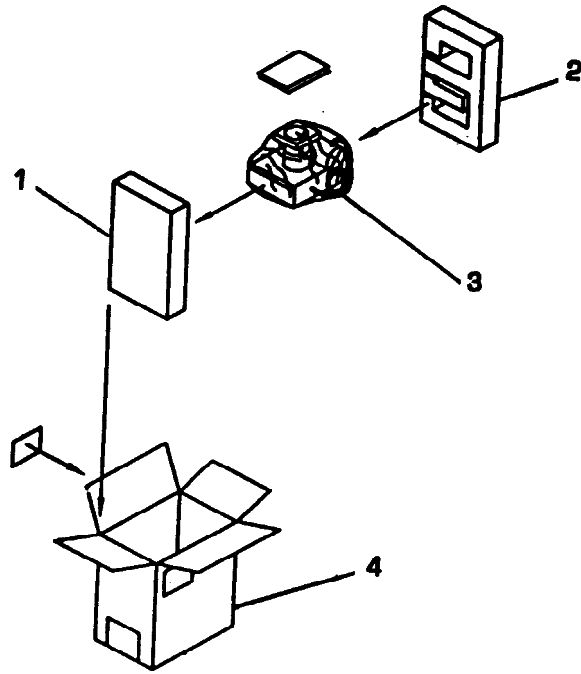

PARTS LIST 10
35MM CAMERA ADAPTER PACKAGING

KEY NO.	PART NO.	PART NAME
1	765884A	End Cap (Left)
2	765883A	End Cap (Right)
3	771243A	Poly Bag
4	765754A	Shipping Container

PARTS LIST 11
ACCESSORIES

KEY NO.	PART NO.		PART NAME
	CI3000	CI5000	HR6000
Accessories:			
1	796997A	796997A	1E0529A
2	796998A	796998A	----
3	1A4136A	1A4136A	----
4	1A4137A	1A4137A	----
5	1A5556A	1A5556A	1A5556A
			Instruction Book
			Instruction Book (Tips)
			Binder
			Slip Case
			Cable IBM PAR PRN